



NEXEN[®]
LIFT TRUCK TECHNOLOGY

FDSL / FGSL35-45

Multi directional brochure



Contents

- Our Philosophy
- Product Highlights
- The Nexen Advantage
- Complication Free Service
- Product Options
- Spec sheets

PHILOSOPHY

The company ethos is to be an **Innovator, not an Imitator.**

The company strives to be the very best in the field of lift truck design by challenging the accepted boundaries of design in order to develop ever more productive and eco-friendly machines.

Nexen products are designed to handle the toughest and most demanding applications and deliver the lowest cost of ownership in the industry.





1 Engine

The complete range is designed for high intensity application, designed to provide continuous strength and reliability. With Yanmar 4TNE98 36Kw & Deutz TD2.9L4 Diesel engines (EU market). GM 2.4L Vortec EPA Carb LPG engine.

2 Drive train

Outstanding performance of the hydrostatic transmission offering perfect power control with the permanent AWD allows smooth easy carrying of loads in the narrow places.

3 Emissions

The oxidation catalyst for EU Stage IIIB and US EPA Tier 4 enables maintenance-free operation under all application and ambient conditions. A particulate filter (DPF) is available as an option. With the introduction of EU Stage V, DPF will be available for all engine types. Through the use of the diesel particulate filter, the engines already comply with the EU StageIV emissions standard from 2019.

4 Nexen Open View Mast

Visibility and Strength the newly designed mast options provide optimal vision when driving, loading & unloading. With high height capacity retention 'Open View' is simply exceptional.

5 Operators Cabin

Built to the highest exacting standards utilising the highest quality components which provides exceptional operator comfort with superior ergonomics which helps alleviate driver fatigue.

6 LED Lights

Low power draw LED lamp outputs an amazing 1000 lumens, providing incredible brightness. The durability and long, maintenance-free life make it a reliable addition to your vehicle. With All direction facing lights as standard & side markers, direction indicators, reverse, brake & "Blue Spot" Warning Light options.

7 Service

The "Ergo" range series trucks like all Nexen models with ultimate ease of maintenance. Class leading accessibility to all serviceable parts.

8 Hydraulics

The FDSL variants are supplied with finger tip control as standard while the European built hydraulic proportional valve offers smooth, controlled, precise lift developed to the most advanced technology and versatility available.

9 Steering

The multi direction steering system or areas where maximum manoeuvring is required in cramped conditions. The 'FDSL' is the only solution. With increased stability over any uneven surfaces the load is absorbed safely and comfortably over the axles.

The Nexen brand is formed with over 50-years experience in the materials handling sector, the Nexen Group has established itself as a reliable and cost effective manufacturer of high quality, innovative products for the materials handling market.

Our aim is to supply a machine fit for purpose that blends with your work flow.

When the idea of Nexen was first created our aim was to support our customers by producing a machine that blends with your work flow. Tough, resilient, built to precision. With British engineering, design and Manufactured. Resulting in the highest quality product available.

Nexen only selects the highest specification components in its commitment to provide quality and reliability to its customers, and to deliver a world-leading product from its ISO9001 production facilities.

The Nexen Ergo-Range represents one of the lowest cost of ownership trucks in its class, giving an excellent return on investment, ensuring maximum performance from the operator and machine at all times.

Nexen is also committed to providing unparalleled after sales support through its Dealer Network, which can offer the following services:

Rapid and fully comprehensive spare parts programme

- Standard, comprehensive or custom warranty programs
- Extensive spare parts held in Lowestoft for next day delivery
- Fully trained on-road service engineers carrying standard spares package

At Nexen, we believe that after sales is just as important as the manufacture of our lift trucks which is why we offer comprehensive service solutions including:

- Full servicing
- Repairs
- After market Spare parts





Nexen prides itself in an Industry leading research and development team. The concept is simple 'Service' is an act of help or assistance – Quality, Maintenance, Repairs, Reliability, Thorough Examination, Training and Management information. Service is exactly what you're getting with the Nexen group.

The Ergo-Range has no comparison when it comes down to design the prime focus is accessibility for service easy and simplified access to all components.

Nexen offer an industry unique service exchange programme to ensure any downtime is kept to the absolute minimum.

- Advanced protection against ingress water and other particles.
- High strength mast
- Informative display to aid in quick diagnostics and fault finding.

Where expensive hidden costs such as service filters, oil change, tyre wear have often increased the annual usage and overall cost of the machine. The Nexen fleet is designed with some of the longest service intervals on the market it can't be beaten. With such design targets in mind as;

- Maintenance-free hydrostatic direct drive
- Maintenance-free brakes
- Reduced tyre wear
- High-performance filter concept allowing fluids life to be doubled before replacing is required.
- Maintenance-free steer axle.
- Good accessibility for maintenance work.

Integrated information is available – technical info, truck history, parts, and data for effective use.

Better safety standards including driver management. With Nexen complete safety, efficiency and cost reduction is a reality and on every truck we produce.

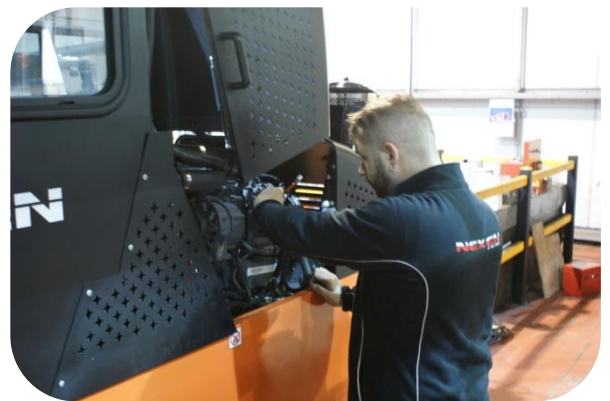

• Standard Spec	○ Optional Spec	FDSL			FGSL		
		35	40	45	35	40	45
Engine							
Yanmar 4TNE98, Stage IIIA		•	•	•			
Deutz TD2.9L4, Sage IV		○	○	○			
GM 2.4L Vortec, EPA Carb LPG.					•	•	•
Mast							
Wide Visibility Duplex, 4000-6000mm		•	•	•	•	•	•
Wide Visibility Duplex Full-free Lift, 4000-6000mm		○	○	○	○	○	○
Open View Triplex Full-free Lift, 4950-9300mm		○	○	○	○	○	○
Hook-on Sideshift		○	○	○	○	○	○
Integrated Sideshift		○	○	○	○	○	○
Fork positioning Sideshift		○	○	○	○	○	○
Extra wide carriage		○	○	○	○	○	○
Removable spreader bar up to 3.5m wide		○	○	○	○	○	○
CHASSIS							
Digital LCD Multifunction Display with Wheel Indicator		•	•	•	•	•	•
Cushion seat		•	•	•	•	•	•
Grammer MSG20 suspension seat, PVC		○	○	○	○	○	○
Grammer MSG20 suspension seat, Fabric		○	○	○	○	○	○
Grammer MSG65 suspension seat, PVC		○	○	○	○	○	○
Grammer MSG65 suspension seat, Fabric		○	○	○	○	○	○
Armrests		○	○	○	○	○	○
Multi functional finger tip control, forward/reverse & Emergency switch		•	•	•	•	•	•
Panoramic Rear View Mirror		○	○	○	○	○	○
Rear View Mirror Left & Right sides		○	○	○	○	○	○
Over Head Guard Plastic Cover		○	○	○	○	○	○
Front Windshield & Roof		○	○	○	○	○	○
Cabin Without Doors		○	○	○	○	○	○
Aircon		○	○	○	○	○	○
Full Steel Weather guard		○	○	○	○	○	○
Heater		○	○	○	○	○	○
Adjustable steering		•	•	•	•	•	•
Clipboard holder		○	○	○	○	○	○
USB port		○	○	○	○	○	○
ELECTRICS							
Headlights, 4 position all direction		○	○	○	○	○	○
Full Road Lighting with indicators and work light		○	○	○	○	○	○
Flashing Beacon		•	•	•	•	•	•
Back-up Alarm		•	•	•	•	•	•

Operator Presence System (OPS)	•	•	•	•	•	•
Blue Light	○	○	○	○	○	○
Weigh load indicator	○	○	○	○	○	○
Height level indicator	○	○	○	○	○	○
Fork positioned camera with LCD display	○	○	○	○	○	○
Reversing Camera with LCD display	○	○	○	○	○	○
Tyre						
Solid Residual Tyre	○	○	○	○	○	○
Non-Marking Tyre	○	○	○	○	○	○
Eco Advance Low Resistance Tyre	○	○	○	○	○	○







Distinguishing mark	1.1	Manufacturer		NEXEN®			
	1.2	Manufacturers type designation		FDSL35	FDSL40	FDSL45	
	1.3	Drive: electric (battery or mains), diesel, petrol, fuel gas		diesel	diesel	diesel	
	1.4	Operator type: hand, pedestrian, standing, seated, order-picker		5410	6140	6400	
	1.5	Load capacity/rated load	Q (kg)	3500	4000	4500	
	1.6	Load centre distance	c (mm)	450	600	600	
Weight	1.9	Wheelbase	y (mm)	1565	1915	2115	
	2.1	Service Weight	kg	5410	2140	6400	
	2.2	Axle loading, laden front/rear	kg				
	2.3	Axle loading, unladen front/rear	kg				
Tyres, chassis	3.1	Tyres: solid rubber, superelastic, pneumatic, polyurethane		solid rubber	solid rubber	solid rubber	
	3.2	Tyre size, front		200/50-15	200/50-15	200/50-15	
	3.3	Tyre size, rear		355/50-15	355/50-15	355/50-15	
	3.5	Wheels, number front rear (x = driven wheels)		2 / 1 (3x)	2 / 1 (3x)	2 / 1 (3x)	
	3.6	Tread, front	b10 (mm)				
	3.7	Tread, rear	b11 (mm)				
Dimensions	4.1	Tilt of mast/fork carriage forward/backward	α/β(°)	3 / 5	3 / 5	3 / 5	
	4.2	Height, mast lowered	h1 (mm)	2855	3015	3015	
	4.3	Free lift	h2 (mm)				
	4.4	Mast working height	h3 (mm)	4000	4000	4000	
	4.5	Height, mast extended	h4 (mm)	4993	5153	5153	
	4.7	Height of overhead guard STD.	h6 (mm)	2450	2450	2450	
	4.8	Seat height/stand height	h7 (mm)				
	4.13	Loading height , unladen	h11 (mm)	193	193	193	
	4.16	Length of loading surface	l3 (mm)				
	4.18	Width of loading surface	b9 (mm)	850	1200	1350	
	4.19	Overall length	l1 (mm)	1950	2300	2500	
	4.20	Length to face of forks	l2 (mm)				
	4.21	Overall width	b1 (mm)	2268	2268	2268	
	4.22	Fork dimensions	L*W*T (mm)	950 * 150 * 50	1220 * 150 * 50	1220 * 150 * 50	
	4.23	Fork carriage DIN 15 173 --- ISO 2328, class/type A,B					
	4.24	Fork arm spread (outside of fork)	b3 (mm)	300 / 1260	300 / 1260	300 / 1260	
	4.25	Distance between fork-arms	b4 (mm)				
	4.31	Ground clearance, laden, below mast	m1 (mm)	177	177	177	
	4.32	Ground clearance, centre of wheelbase	m (mm)	185	185	185	
	4.33	Aisle width for pallets 1000 x 1200 crossways	Ast (mm)	2435	2554	2630	
	4.34	Aisle width for pallets 800 x 1200 lengthways	Ast (mm)	2435	2554	2630	
	4.35	Turning radius, Forward / Sideways	Wa (mm)	2055 / 1500	2354 / 1590	2530 / 1700	
	4.36	Internal turning radius	b13 (mm)	2055	2354	2530	
	Performance data	5.1	Travel speed, laden/unladen	km/h	12	12	12
		5.2	Lift speed, laden/unladen	m/s	330 / 400	330 / 400	330 / 400
		5.3	Lowering speed, laden/unladen	m/s	410 / 380	400 / 370	400 / 370
5.6		Max. Drawbar pull, laden/unladen	N				
5.7		Gradeability, laden/unladen	%	15	15	15	
5.10		Service brake					
	5.11	Parking brake					
Combustion-engine	7.1	Engine Manufacturer / Type		Duetz / TD 2.9 L4	Duetz / TD 2.9 L4	Duetz / TD 2.9 L4	
	7.2	Engine power acc. to ISO 1585	kW	55.4	55.4	55.4	
	7.3	Rated speed	rpm	2600	2600	2600	
	7.4	No. of cylinders / displacement	CM³				
	7.5	Fuel consumption acc. VDI cycle	l / h	4.5	4.5	4.5	
Addition data	8.1	Type of drive control					
	8.2	Operating pressure for attachments	bar	200	200	200	
	8.3	Oil volume for attachments	l/min				
	8.4	Sound level at the driver´s ear according to EN / DIN 12 053	dB (A)	75	75	75	

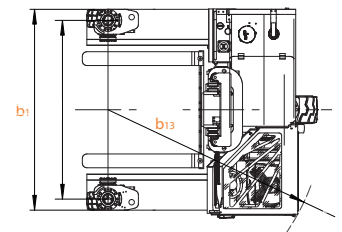
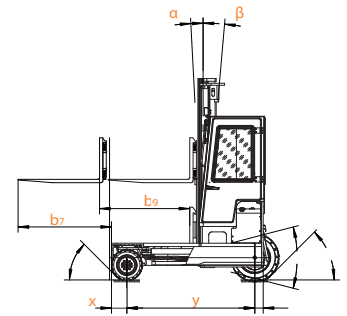
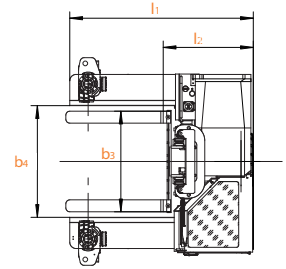
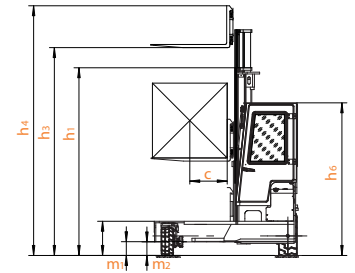

				NEXEN®			
Distinguishing mark	1.1	Manufacturer					
	1.2	Manufacturers type designation		FDSL35	FDSL40	FDSL45	
	1.3	Drive: electric (battery or mains), diesel, petrol, fuel gas		diesel	diesel	diesel	
	1.4	Operator type: hand, pedestrian, standing, seated, order-picker		5410	6140	6400	
	1.5	Load capacity/rated load	Q (kg)	3500	4000	4500	
	1.6	Load centre distance	c (mm)	450	600	600	
Weight	1.9	Wheelbase	y (mm)	1565	1915	2115	
	2.1	Service Weight	kg	5410	2140	6400	
	2.2	Axle loading, laden front/rear	kg				
	2.3	Axle loading, unladen front/rear	kg				
Tyres, chassis	3.1	Tyres: solid rubber, superelastic, pneumatic, polyurethane		solid rubber	solid rubber	solid rubber	
	3.2	Tyre size, front		200/50-15	200/50-15	200/50-15	
	3.3	Tyre size, rear		355/50-15	355/50-15	355/50-15	
	3.5	Wheels, number front rear (x = driven wheels)		2 / 1 (3x)	2 / 1 (3x)	2 / 1 (3x)	
	3.6	Tread, front	b10 (mm)				
	3.7	Tread, rear	b11 (mm)				
Dimensions	4.1	Tilt of mast/fork carriage forward/backward	α/β(°)	3 / 5	3 / 5	3 / 5	
	4.2	Height, mast lowered	h1 (mm)	2855	3015	3015	
	4.3	Free lift	h2 (mm)				
	4.4	Mast working height	h3 (mm)	4000	4000	4000	
	4.5	Height, mast extended	h4 (mm)	4993	5153	5153	
	4.7	Height of overhead guard STD.	h6 (mm)	2450	2450	2450	
	4.8	Seat height/stand height	h7 (mm)				
	4.13	Loading height , unladen	h11 (mm)	193	193	193	
	4.16	Length of loading surface	l3 (mm)				
	4.18	Width of loading surface	b9 (mm)	850	1200	1350	
	4.19	Overall length	l1 (mm)	1950	2300	2500	
	4.20	Length to face of forks	l2 (mm)				
	4.21	Overall width	b1 (mm)	2268	2268	2268	
	4.22	Fork dimensions	L*W*T (mm)	950 * 150 * 50	1220 * 150 * 50	1220 * 150 * 50	
	4.23	Fork carriage DIN 15 173 --- ISO 2328, class/type A,B					
	4.24	Fork arm spread (outside of fork)	b3 (mm)	300 / 1260	300 / 1260	300 / 1260	
	4.25	Distance between fork-arms	b4 (mm)				
	4.31	Ground clearance, laden, below mast	m1 (mm)	177	177	177	
	4.32	Ground clearance, centre of wheelbase	m (mm)	185	185	185	
	Performance data	4.33	Aisle width for pallets 1000 x 1200 crossways	AsT (mm)	2435	2554	2630
		4.34	Aisle width for pallets 800 x 1200 lengthways	AsL (mm)	2435	2554	2630
4.35		Turning radius, Forward / Sideways	Wa (mm)	2055 / 1500	2354 / 1590	2530 / 1700	
4.36		Internal turning radius	b13 (mm)	2055	2354	2530	
5.1		Travel speed, laden/unladen	km/h	12	12	12	
5.2		Lift speed, laden/unladen	m/s	330 / 400	330 / 400	330 / 400	
5.3		Lowering speed, laden/unladen	m/s	410 / 380	400 / 370	400 / 370	
5.6		Max. Drawbar pull, laden/unladen	N				
5.7		Gradeability, laden/unladen	%	15	15	15	
5.10		Service brake					
5.11		Parking brake					
Combustion-engine	7.1	Engine Manufacturer / Type		Yanmar / 4TNE98	Yanmar / 4TNE98	Yanmar / 4TNE98	
	7.2	Engine power acc. to ISO 1585	kW	43.7	43.7	43.7	
	7.3	Rated speed	rpm	2300	2300	2300	
	7.4	No. of cylinders / displacement	CM³				
	7.5	Fuel consumption acc. VDI cycle	l / h	2.7	2.7	2.7	
Addition data	8.1	Type of drive control					
	8.2	Operating pressure for attachments	bar	200	200	200	
	8.3	Oil volume for attachments	l/min				
	8.4	Sound level at the driver´s ear according to EN / DIN 12 053	dB (A)	75	75	75	

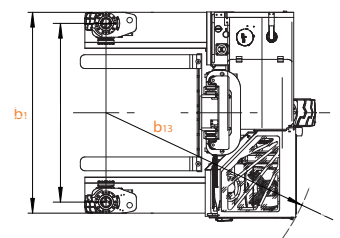
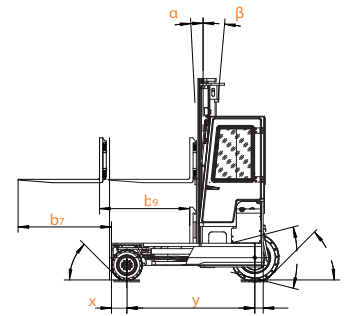
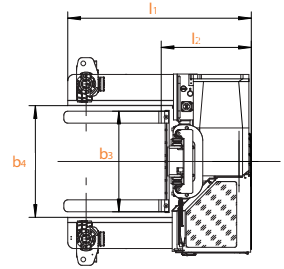
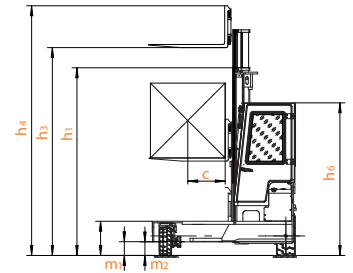

Distinguishing mark	1.1	Manufacturer		NEXEN®			
	1.2	Manufacturers type designation		FGSL35	FGSL40	FGSL45	
	1.3	Drive: electric (battery or mains), diesel, petrol, fuel gas		LPG	LPG	LPG	
	1.4	Operator type: hand, pedestrian, standing, seated, order-picker		5410	6140	6400	
	1.5	Load capacity/rated load	Q (kg)	3500	4000	4500	
	1.6	Load centre distance	c (mm)	450	600	600	
	1.9	Wheelbase	y (mm)	1565	1915	2115	
	Weight	2.1	Service Weight	kg	5410	2140	6400
		2.2	Axle loading, laden front/rear	kg			
2.3		Axle loading, unladen front/rear	kg				
Tyres, chassis	3.1	Tyres: solid rubber, superelastic, pneumatic, polyurethane		solid rubber	solid rubber	solid rubber	
	3.2	Tyre size, front		200/50-15	200/50-15	200/50-15	
	3.3	Tyre size, rear		355/50-15	355/50-15	355/50-15	
	3.5	Wheels, number front rear (x = driven wheels)		2 / 1 (3x)	2 / 1 (3x)	2 / 1 (3x)	
	3.6	Tread, front	b10 (mm)				
	3.7	Tread, rear	b11 (mm)				
Dimensions	4.1	Tilt of mast/fork carriage forward/backward	α/β(°)	3 / 5	3 / 5	3 / 5	
	4.2	Height, mast lowered	h1 (mm)	2855	3015	3015	
	4.3	Free lift	h2 (mm)				
	4.4	Mast working height	h3 (mm)	4000	4000	4000	
	4.5	Height, mast extended	h4 (mm)	4993	5153	5153	
	4.7	Height of overhead guard STD.	h6 (mm)	2450	2450	2450	
	4.8	Seat height/stand height	h7 (mm)				
	4.13	Loading height , unladen	h11 (mm)	193	193	193	
	4.16	Length of loading surface	l3 (mm)				
	4.18	Width of loading surface	b9 (mm)	850	1200	1350	
	4.19	Overall length	l1 (mm)	1950	2300	2500	
	4.20	Length to face of forks	l2 (mm)				
	4.21	Overall width	b1 (mm)	2268	2268	2268	
	4.22	Fork dimensions	L*W*T (mm)	950 * 150 * 50	1220 * 150 * 50	1220 * 150 * 50	
	4.23	Fork carriage DIN 15 173 --- ISO 2328, class/type A,B					
	4.24	Fork arm spread (outside of fork)	b3 (mm)	300 / 1260	300 / 1260	300 / 1260	
	4.25	Distance between fork-arms	b4 (mm)				
	4.31	Ground clearance, laden, below mast	m1 (mm)	177	177	177	
	4.32	Ground clearance, centre of wheelbase	m (mm)	185	185	185	
	4.33	Aisle width for pallets 1000 x 1200 crossways	Ast (mm)	2435	2554	2630	
	4.34	Aisle width for pallets 800 x 1200 lengthways	Ast (mm)	2435	2554	2630	
	4.35	Turning radius, Forward / Sideways	Wa (mm)	2055 / 1500	2354 / 1590	2530 / 1700	
	4.36	Internal turning radius	b13 (mm)	2055	2354	2530	
	Performance data	5.1	Travel speed, laden/unladen	km/h	12	12	12
		5.2	Lift speed, laden/unladen	m/s	330 / 400	330 / 400	330 / 400
		5.3	Lowering speed, laden/unladen	m/s	410 / 380	400 / 370	400 / 370
5.6		Max. Drawbar pull, laden/unladen	N				
5.7		Gradeability, laden/unladen	%	15	15	15	
5.10		Service brake					
	5.11	Parking brake					
Combustion-engine	7.1	Engine Manufacturer / Type		GM / 2.4L Vortec	GM / 2.4L Vortec	GM / 2.4L Vortec	
	7.2	Engine power acc. to ISO 1585	kW	52	52	52	
	7.3	Rated speed	rpm	2700	2700	2700	
	7.4	No. of cylinders / displacement	CM³				
	7.5	Fuel consumption acc. VDI cycle	l / h	2.8	2.8	2.8	
Addition data	8.1	Type of drive control					
	8.2	Operating pressure for attachments	bar	200	200	200	
	8.3	Oil volume for attachments	l/min				
	8.4	Sound level at the driver´s ear according to EN / DIN 12 053	dB (A)	75	75	75	

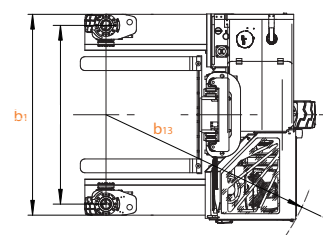
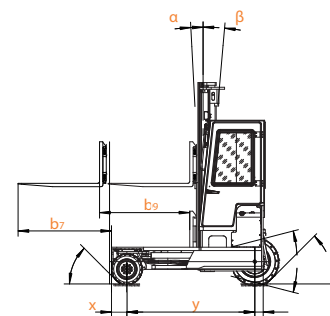
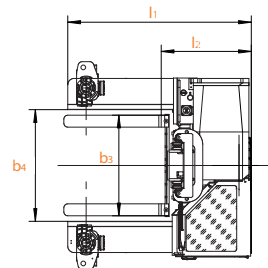
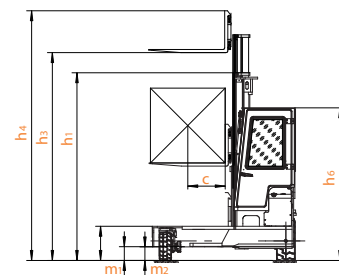

MAST		LIFTING HEIGHT (mm)	OVERALL HEIGHT MAST LOWERED (mm)			OVERALL HEIGHT MAST EXTENDED (mm)			Free lift (mm)	Front Overhang (mm)			MAST TILTING ANGLE FRONT/REAR	CAPACITY AT MAX. HEIGHT (Kg)		
			3. 5T	4. 0T	4. 5T	3. 5T	4. 0T	4. 5T		3. 5T	4. 0T	4. 5T		3. 5T	4. 0T	4. 5T
DUPLEX	3. 3m	3300	2505	2665	2665	4293	4453	4453	0	360	365	365	3° -5°	3500	4000	4500
	4. 0m	4000	2855	3015	3015	4993	5153	5153	0	360	365	365	3° -5°	3165	3665	4165
	4. 5m	4500	3105	3265	3265	5493	5653	5653	0	360	365	365	3° -5°	2950	3450	3950
	5. 0m	5000	3355	3515	3515	5993	6153	6153	0	360	365	365	3° -5°	2725	3225	3725
	5. 5m	5500	3655	3815	3815	6493	6653	6653	0	360	365	365	3° -5°	2500	3000	3500
	6. 0m	6000	3905	4065	4065	6993	7153	7153	0	360	365	365	3° -5°	2280	2780	3280
	6. 5m	6500	4195	4355	4355	7493	7653	7653	0	360	365	365	3° -5°	2000	2500	3000
DUPLEX FFL	3. 3m	3300	2505	2665	2665	4293	4453	4453	1594	370	375	375	3° -5°	3500	4000	4500
	4. 0m	4000	2855	3015	3015	4993	5153	5153	1944	370	375	375	3° -5°	3165	3665	4165
	4. 5m	4500	3105	3265	3265	5493	5653	5653	2194	370	375	375	3° -5°	2950	3450	3950
	5. 0m	5000	3355	3515	3515	5993	6153	6153	2444	370	375	375	3° -5°	2725	3225	3725
	5. 5m	5500	3655	3815	3815	6493	6653	6653	2744	370	375	375	3° -5°	2500	3000	3500
	6. 0m	6000	3905	4065	4065	6993	7153	7153	2994	370	375	375	3° -5°	2280	2780	3280
	6. 5m	6500	4195	4355	4355	7493	7653	7653	3284	370	375	375	3° -5°	2000	2500	3000
TRIPLEX FFL	4. 0m	4000	2103	2173	2173	4893	4963	4963	1189	413	418	418	3° -5°	2865	3365	3865
	4. 5m	4500	2279	2349	2349	5393	5463	5463	1365	413	418	418	3° -5°	2650	3150	3650
	5. 0m	5000	2478	2548	2548	5893	5963	5963	1561	413	418	418	3° -5°	2425	2925	3425
	5. 4m	5400	2603	2673	2673	6293	6363	6363	1689	413	418	418	3° -5°	2200	2750	3200
	5. 6m	5600	2667	2737	2737	6493	6563	6563	1753	413	418	418	3° -5°	2160	2660	3160
	6. 0m	6000	2843	2913	2913	6893	6963	6963	1929	413	418	418	3° -5°	1980	2480	2980
	6. 5m	6500	3043	3113	3113	7393	7463	7463	2129	413	418	418	3° -5°	1700	2200	2700





The No. 1# choice Material Handling supplier for the world's demanding market

Nexen is committed to being much more than just a lift truck supplier.
Our aim is to offer a complete managed materials handling solution for your growing needs.

Whatever your materials handling or fleet management needs you can count on Nexen through its network of highly trained dealers to provide expert, effective and responsive local support.

They can also offer rapid response parts support as well as cost effective finance packages and introduce effectively managed fleet maintenance programs to ensure that you get the best possible support at the best possible value.

Corporate Headquarters:

Nexen Lift Trucks Ltd.,
Riverside Road,
Lowestoft,
Suffolk
NR33 0TU
UK

Tel: +44 1502 532 211
US Office: +1 562 661 8213
Fax: +44 1502 508 273

Mail: info@nexengroup.co.uk
Web: www.nexenlifttrucks.com